

BUILDING ELEVATION	MATERIAL DESCRIPTION	TOTAL SQ.FT	PROVIDED	REQUIRED
TOWNHOME	BRICK/STONE	3,720	80%	80%
	STUCCO	185	4%	20%
	GLASS	720	16%	
TOTAL		4,625	100%	

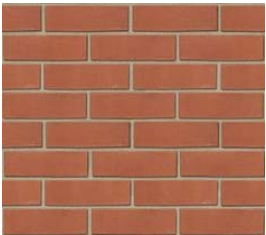

BRICK



COOL GRAY STUCCO



WINDOW SILL



WALL SCONCE LIGHT

EXTERIOR MATERIAL



TOWNHOUSE - CONCEPTUAL ELEVATION

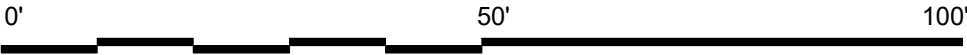









MATERIAL LEGEND

	BRICK 1		STUCCO 1
	BRICK 2		STUCCO 2
	METAL PANEL		STUCCO 3

MATERIAL CALCULATION

BRICK	- 61%
STUCCO	- 38%
METAL PANEL	- 1%

KEY PLAN

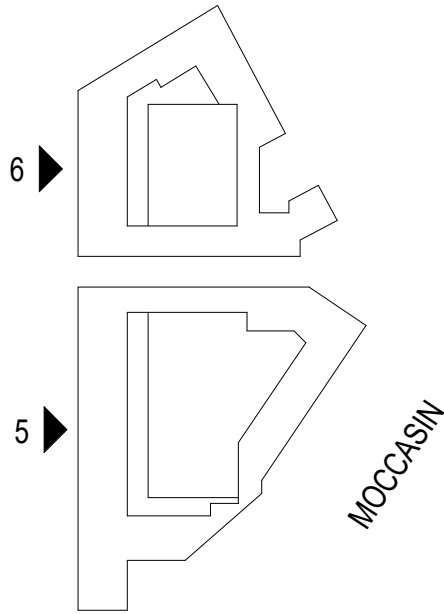

ARCHITECTURE **DEMAREST**  
2320 Valdina Street,  
Dallas, TX 75207  
Tel: 214.748.6655  
www.architecturedemarest.com

Copyright Reserved

Consultants

Client/Project  
PROJECT NUMBER: 20039

**FRONTERRA MULTIFAMILY**  
LEON CAPITAL GROUP  
LEWISVILLE, TEXAS

Project Status - [Issue Date]

Revision	YYYY.MM.DD
Issued	YYYY.MM.DD
Author	Checker
Drawn By	Reviewed By

Permit-Seal

**PRELIMINARY  
NOT FOR CONSTRUCTION**  
Not for permits, pricing or other  
official purposes.  
This document has not been  
completed or checked and is for  
general information or comment  
only.

Title  
**CONCEPTUAL BUILDING  
ELEVATIONS**

Scale  
As indicated

Revision  
Drawing No.

**A11**





BUILDING 2

BUILDING 1



1800 VALLEY VIEW LN, STE 400. FARMERS BRANCH, TX 75234  
PHONE 469-857-3151

FRONTERRA

Enter address here

MULTIFAMILY- CONCEPTUAL  
ELEVATIONS

AP.10



