

# Location Map - Fronterra

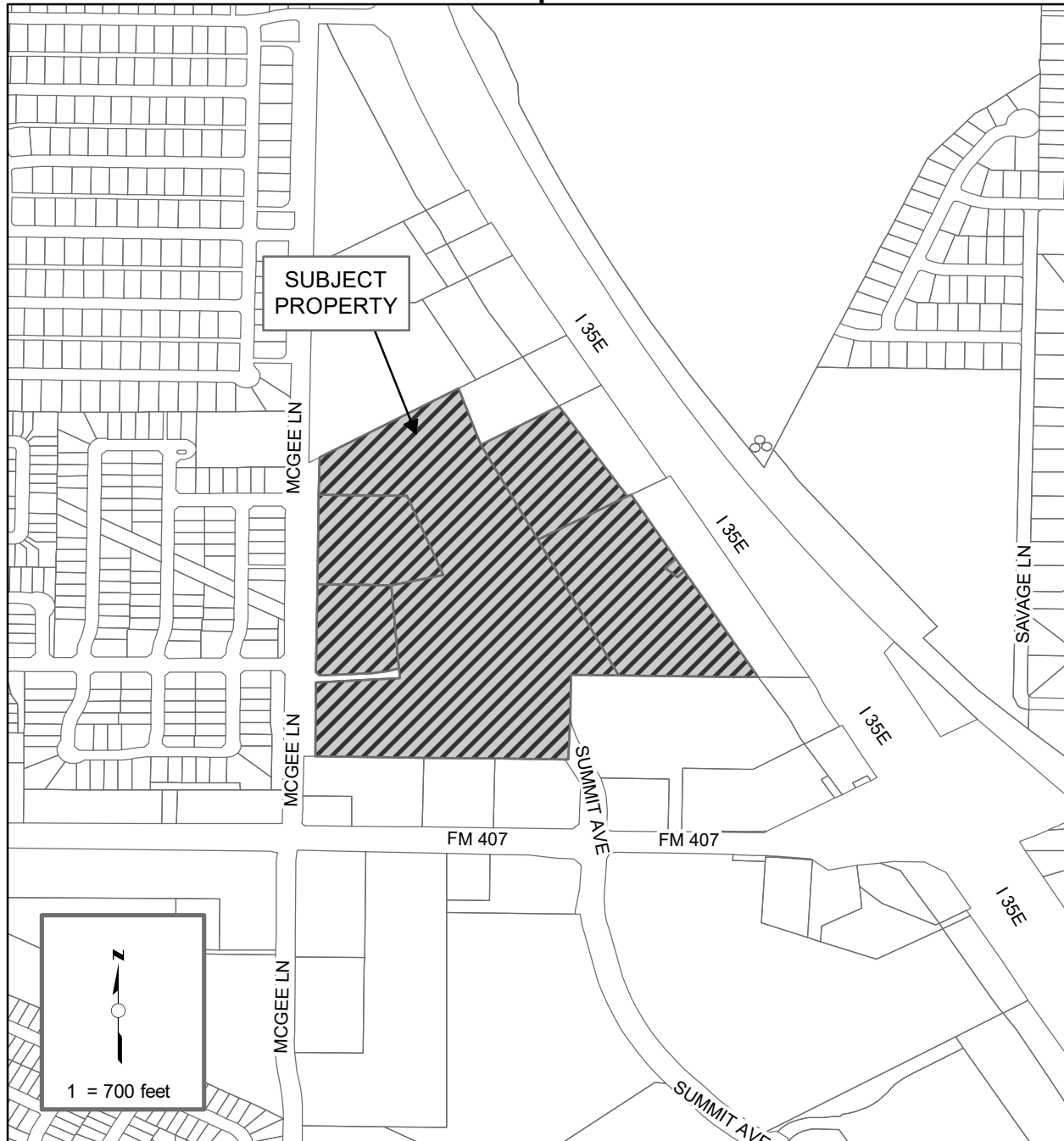

## **ZONING CASE NO. 20-01-1-PZ**

**PROPERTY OWNERS:** MEHRDAD MOAYEDI, MM FRONTERRA 35, LLC

**APPLICANT:** RANDI RIVERA, MCADAMS

**PROPERTY LOCATION:** P.K. WAGGONER SURVEY, ABSTRACT NUMBER 1342 (35.825-ACRES)  
LOCATED WEST OF INTERSTATE HIGHWAY 35E AND EAST OF MCGEE  
LANE AT THE NORTHERN TERMINUS OF SUMMIT ROAD.

**CURRENT ZONING:** LIGHT INDUSTRIAL DISTRICT (LI)

**REQUESTED ZONING:** PLANNED DEVELOPMENT – MIXED USE DISTRICT (PD-MU)