

OWNER / DEVELOPER
DICKEY PROPERTIES
 P. O. BOX 836004
 RICHARDSON, TEXAS 75083

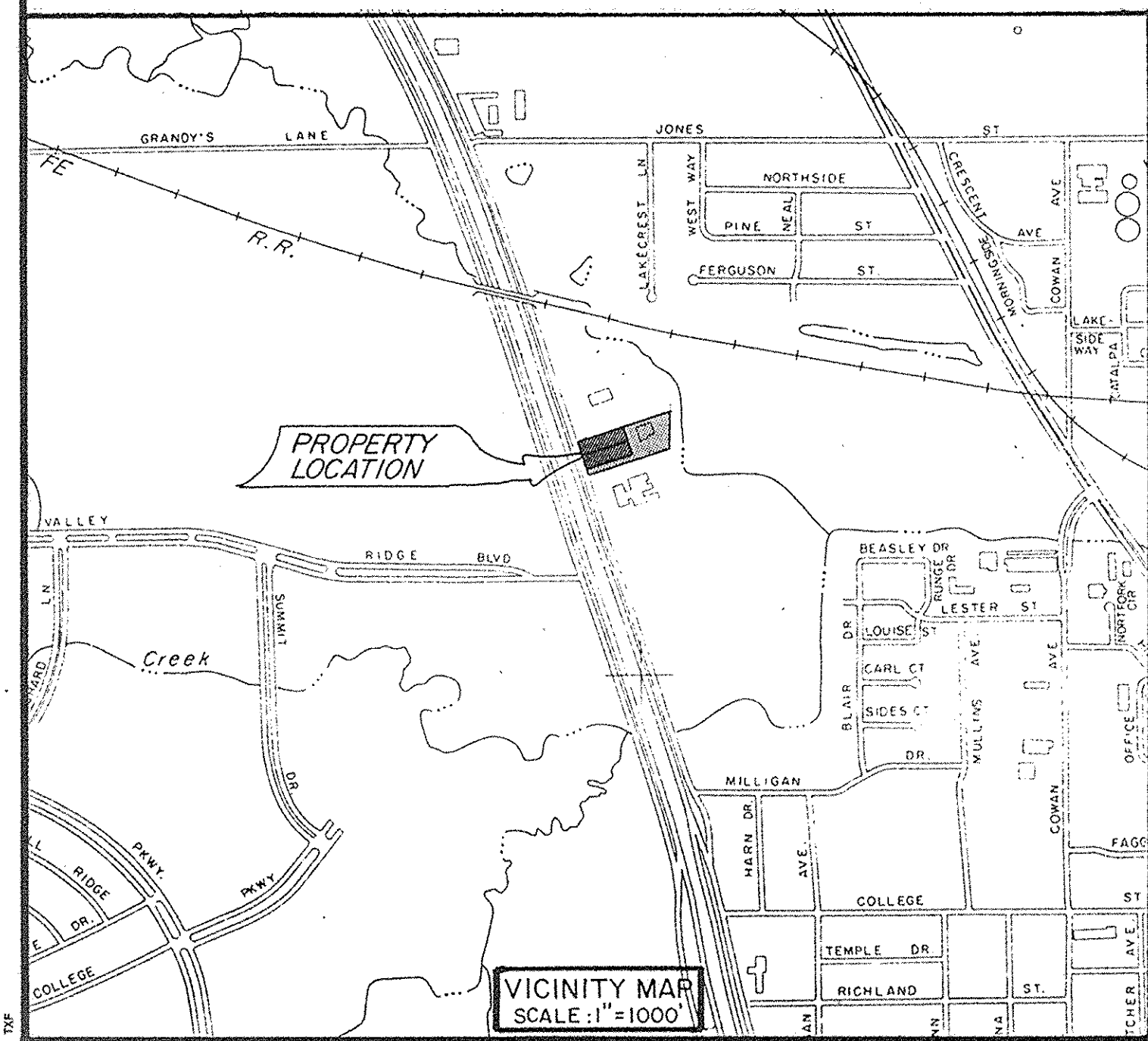

SURVEYOR'S CERTIFICATE
 The plat hereon correctly represents a survey made under my supervision, and all the lot corners and boundary markers are correctly placed as shown.
W. Steven Gilbreath
 W. Steven Gilbreath
 Registered Public Surveyor No. 2777
 P. O. Box 1398
 Lewisville, Texas 75067
 Date 5/9/88

VARIANCE REQUESTED: All portions of lot are not within 300' of a fire hydrant.
Recommended for approval
Larry E. Smith 6/6/88
 Larry E. Smith
 Chairman, Planning and Zoning Commission
 City of Lewisville, Texas
Approved and Accepted
Donny Daniel 6/6/88
 Donny Daniel
 Mayor, City of Lewisville, Texas

THE UNDERSIGNED, the City Secretary of Lewisville, Texas, hereby certifies that the foregoing Interstate Thirty-Five North Addition, an addition to the City of Lewisville, Texas, was submitted to the appropriate Planning and Zoning Commission or City Council as required by the ordinance of the City of Lewisville on the 6th day of June, 1988, and such body by formal action, then and there, accepted the dedication of streets, alleys, parks, easements, public places, and water and sewer lines, and said body further authorized the acceptance thereof by signing as hereinabove subscribed in the capacity stated.
WITNESS MY HAND this 6th day of June, A.D., 1988.
Betty Harris
 Betty Harris
 City Secretary
 City of Lewisville, Texas

29112
 FILED FOR RECORD
 88 JUN 23 PM 1:31
 COUNTY CLERK
 W. STEVEN GILBREATH
 DEPUTY
 G-338

OWNER'S CERTIFICATE AND DEDICATION

STATE OF TEXAS :
COUNTY OF DENTON: WHEREAS, We, Dickey Properties Joint Venture, are the owners of the following described property:

Being all that certain lot, tract or parcel of land situated in the E. Brown Survey, Abstract Number 62, City of Lewisville, Denton County, Texas, and being part of Lot 1, Block A, Interstate Thirty-Five North Addition, an addition to the City of Lewisville, Denton County, Texas, also recorded in Cabinet B, Page 359, Plat Records, Denton County, Texas, also being all of Lot 1, Block A of the Replat of Interstate Thirty-Five North Addition, as recorded in Cabinet C, Page 79, Plat Records, Denton County, Texas, and being more particularly described as follows:

BEGINNING at an iron rod found for corner in the easterly right-of-way line of Interstate Highway No. 35E (300' R.O.W.), said point being South 17°13'27" East, 793.01 feet from the point of intersection of the easterly right-of-way line of Interstate Highway 35E with the southerly right-of-way line of the Gulf, Colorado and Santa Fe Railroad;

THENCE North 72°46'33" East, 328.00 feet to an iron rod found for corner in a fence;

THENCE South 17°13'27" East, 210.00 feet to an iron rod found for corner;

THENCE South 72°46'33" West, 328.00 feet to an iron rod found for corner in the easterly right-of-way line of Interstate Highway 35E;

THENCE North 17°13'27" West, along the easterly right-of-way line of Interstate Highway 35E, 210.00 feet to the **POINT OF BEGINNING** and containing approximately 68,880 square feet, or 1.581 acres of land.

NOW, THEREFORE, KNOW ALL MEN BY THESE PRESENTS:
THAT WE, Dickey Properties Joint Venture, do adopt this plat designating the hereinabove described property as a final plat of Lots 1A and 1B, Block A, and being a replat of Lot 1, Block A, of Interstate Thirty-Five North Addition, an addition to the City of Lewisville, Denton County, Texas, and do hereby dedicate to the public use forever all utility easements, drainage easements, and streets as shown hereon. All and any public utilities shall have full right to remove and keep removed all growths which may endanger or interfere with the construction, maintenance, or efficiency of its respective system on the utility easement for the purpose of constructing, reconstructing, inspecting, patrolling, maintaining, and adding or removing all or part of its respective systems without the necessity at any time of procuring the permission of anyone.

WITNESS MY HAND this 12th day of May, 1988.

Authorized Agent
 Dickey Properties Joint Venture
 Rolanda Dickey

STATE OF TEXAS :
COUNTY OF DENTON: BEFORE ME, the undersigned authority, on this day personally appeared ROLANDA DICKEY, known to me to be the person whose name is subscribed to the foregoing instrument and acknowledged to me that he executed the same for the purpose and consideration therein expressed, and in the capacity therein stated.

GIVEN UNDER MY HAND AND SEAL OF OFFICE on this 12th day of May, 1988.

Natalie C. Kuyper
 Notary Public, State of Texas
 My commission expires the 17th day of March, 1991.

FINAL PLAT
LOTS 1A & 1B
INTERSTATE THIRTY-FIVE
NORTH ADDITION
 (A REPLAT OF LOT 1, BLOCK A)

1.581 ACRES

IN THE
 E. BROWN SURVEY ABST. 62
 CITY OF LEWISVILLE
 DENTON COUNTY, TEXAS

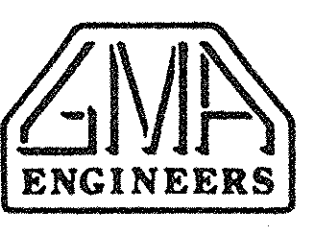

Gilbreath, McDill & Associates, Inc.
 CONSULTING ENGINEERS - LAND SURVEYORS

P.O. Box 1398
 Lewisville, Texas 75067
 (214) 436-9712
 P.O. Box 428
 Waxahachie, Texas 75165
 (214) 223-9825

DRAWN BY: HENRY DATE: APRIL 29, 1988 JOB NO.: **882515**

Rezoning Metes and Bounds

BEGINNING at an iron rod found for corner in the easterly right-of-way line of Interstate Highway No. 35E (300' R.O.W.), said point being South 17°13'27" East, 793.01 feet from the point of intersection of the easterly right-of-way line of Interstate Highway 35E with the southerly right-of-way line of the Gulf, Colorado and Santa Fe Railroad;

THENCE North 72°46'33" East, 120.00 feet to an iron rod found for corner in a fence;

THENCE South 17°13'27" East, 210.00 feet to an iron rod found for corner;

THENCE South 72°46'33" West, 120.00 feet to an iron rod found for corner in the easterly right-of-way line of Interstate Highway 35E;

THENCE North 17°13'27" West, along the easterly right-of-way line of Interstate Highway 35E, 210.00 feet to the **POINT OF BEGINNING** and containing approximately 25,200 square feet, or 0.5785 acres of land.