

Location Map - RaceTrac

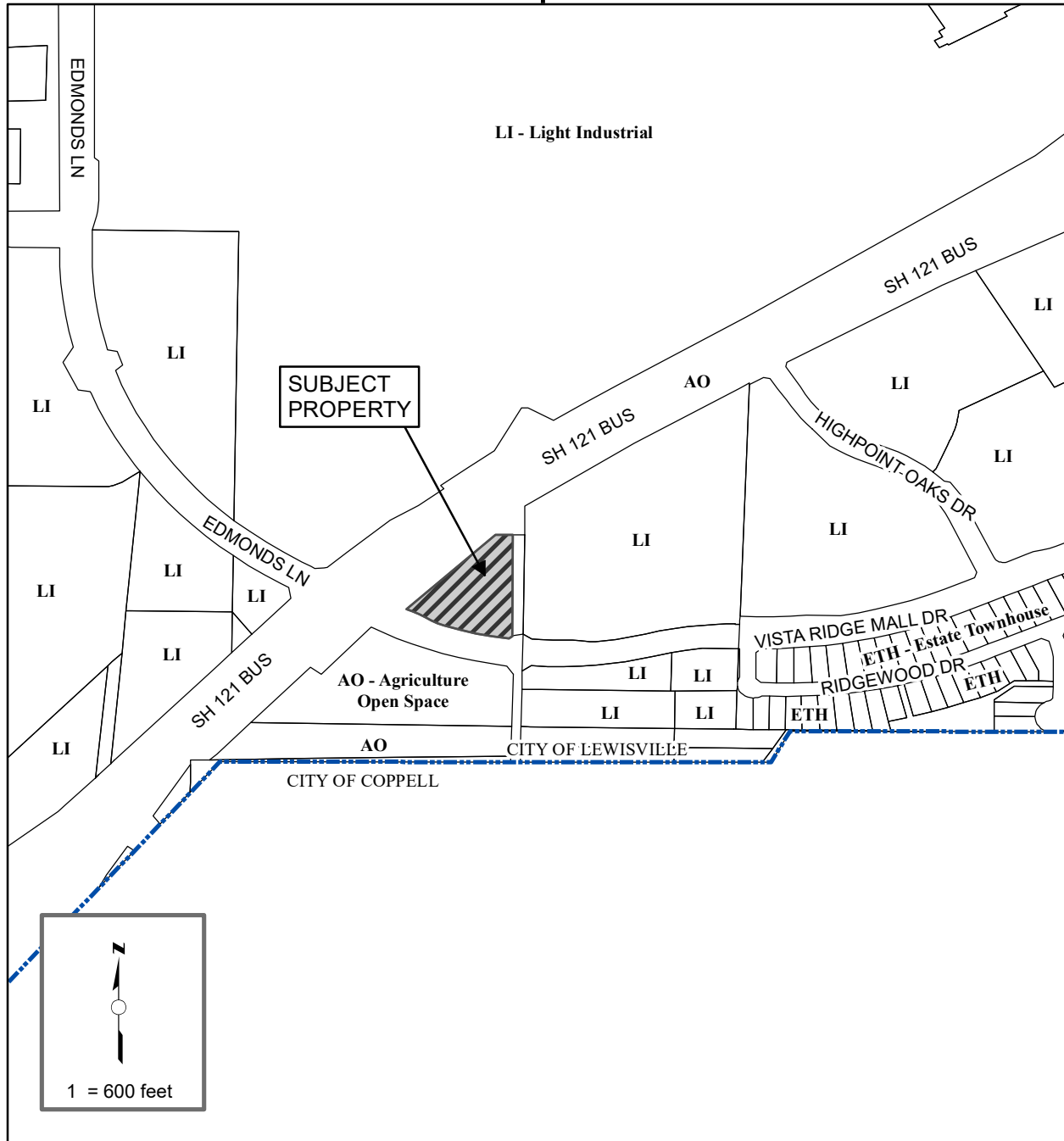

CASE NO. SUP-2018-09-13

PROPERTY OWNER: HAWKEYE REALTY SCHREIBER, LP

APPLICANT NAME: ANDREW MALZER, RACETRAC PETROLEUM, INC.

PROPERTY LOCATION: TRACT OUT OF THE P. HARMONSON SURVEY, ABSTRACT NO. 604 (2.026-ACRES) LOCATED ON THE NORTHEAST CORNER OF STATE HIGHWAY 121 BUSINESS AND WEST VISTA RIDGE MALL DRIVE

CURRENT ZONING: AGRICULTURE OPEN SPACE DISTRICT (AO), REQUESTED ZONING LIGHT INDUSTRIAL DISTRICT (LI)

REQUESTED USE: A SPECIAL USE PERMIT (SUP) FOR A GASOLINE SERVICE STATION