

LOT 11
FAIRWAY BUSINESS PARK
C&B W. 25.0X1 905
PARCEL NO. 215219
BRAZOS ELECTRIC POWER
CONSUMERS INC.
INSTRUMENT NO. 99-48227
D.I.S.C.T.
ZONING LI

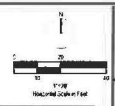

BUILDING DATA					
BUILDING	DEPTH (FT)	WIDTH (FT)	# OF STORIES	# OF COLUMNS	SETOFF (IN)
BUILDING NO. 206	1	1	1	1	1800

BUILDING SETBACKS	
TYPE	SETBACK (FEET)
FRONT YARD COURTYARD	5.0
FRONT YARD	5.0
REAR YARD	5.0
SIDE YARD	5.0
REAR COURTYARD	5.0

LANDSCAPE SETBACKS	
TYPE	SETBACK (FEET)
FRONT YARD	5.0
REAR YARD	5.0
SIDE YARD	5.0
REAR COURTYARD	5.0

PARKING SPACES	
TYPE	NUMBER
STANDARD	10
COMPACT	10
TOTAL	20

LAND USE DATA	
TYPE	AREA (SQ. FT.)
RESIDENTIAL	0
COMMERCIAL	0
INDUSTRIAL	0
TOTAL	0

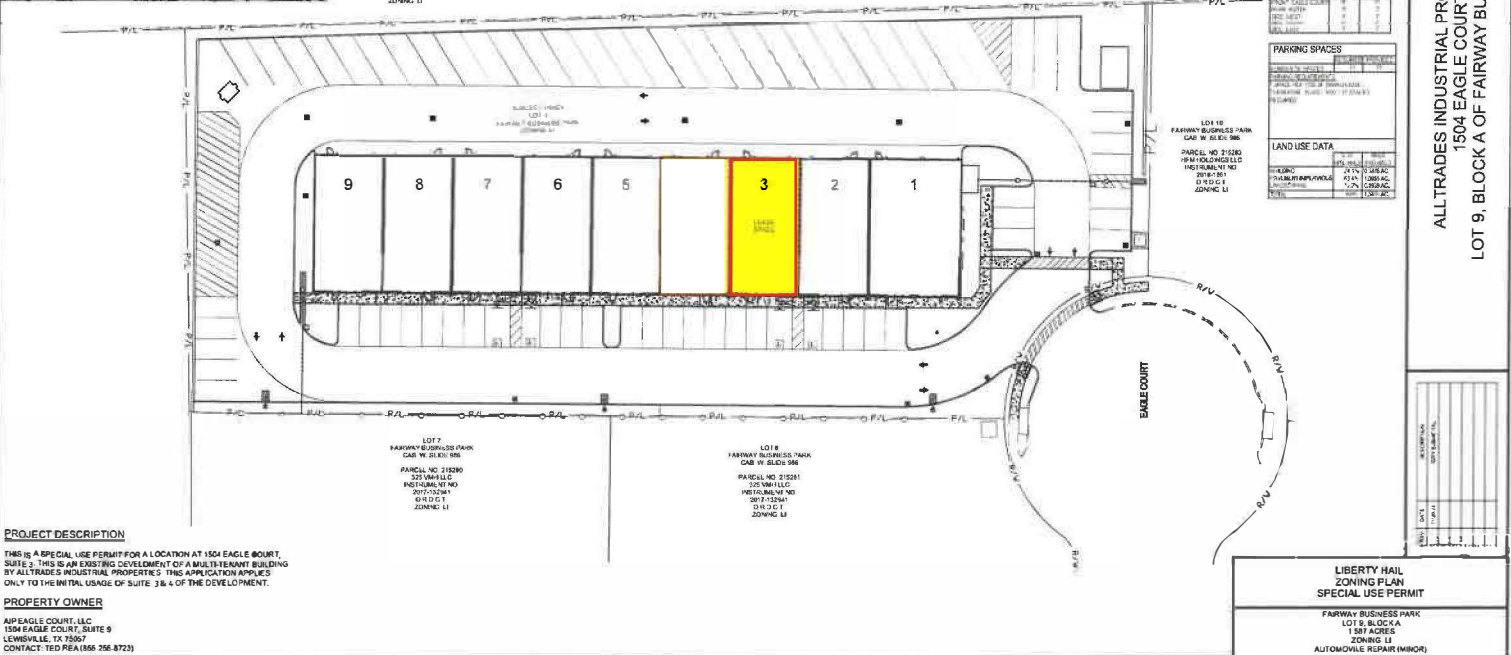

LOT 7
FAIRWAY BUSINESS PARK
C&B W. 25.0X1 905
PARCEL NO. 215206
25.0X1 905
INSTRUMENT NO. 2017-02284
D.I.S.C.T.
ZONING LI

LOT 8
FAIRWAY BUSINESS PARK
C&B W. 25.0X1 905
PARCEL NO. 215201
25.0X1 905
INSTRUMENT NO. 2017-02281
D.I.S.C.T.
ZONING LI

LOT 10
FAIRWAY BUSINESS PARK
C&B W. 25.0X1 905
PARCEL NO. 215203
25.0X1 905
INSTRUMENT NO. 2017-02281
D.I.S.C.T.
ZONING LI

PROJECT DESCRIPTION
THIS IS A SPECIAL USE PERMIT FOR A LOCATION AT 1504 EAGLE COURT, SUITE 9. THIS IS AN EXISTING DEVELOPMENT OF A MULTITENANT BUILDING BY ALL TRADES INDUSTRIAL PROPERTIES. THIS APPLICATION APPLIES ONLY TO THE INITIAL USAGE OF SUITE 3 & 4 OF THE DEVELOPMENT.

PROPERTY OWNER
AIR EAGLE COURT, LLC
1504 EAGLE COURT, SUITE 9
LEWISVILLE, TX 75067
CONTACT: TED REA (562 356 8723)

LIBERTY HAIL ZONING PLAN SPECIAL USE PERMIT

FAIRWAY BUSINESS PARK
LOT 9, BLOCK A
1.97 ACRES
ZONING LI
AUTOMOBILE REPAIR (MINOR)



ALL TRADES INDUSTRIAL PROPERTIES
1504 EAGLE COURT
LOT 9, BLOCK A OF FAIRWAY BUSINESS PARK