



Lewisville City Council

June 19, 2023

The vision...

Copyright Serve Lewisville 2023





Serve Lewisville chronology

Date	Event
June 29, 2021	City Manager and staff visit Serve Denton
July 23, 2021	City Council visit, ask for feasibility study proposal
October 7, 2021	Kickoff feasibility study
January 15, 2022	Community visioning session
July 17, 2022	Feasibility study presentation to City Council approved
November 7, 2022	City Council approves loan agreement
November 9, 2022	Close on old DATCU Credit Union property purchase
December 23, 2022	Demolition completion
March 23, 2023	Construction begins
June 13, 2023	Construction complete
June 24, 2023	Volunteer work day
July 20, 2023	Ribbon cutting! Please join us at 9 am
Q2/2024	Close on NMTC Deal for Phase 2
Q2/2025	Open Phase 2



Serve Lewisville is a public-private partnership

Mission: to partner with the Lewisville community to help more people in need.

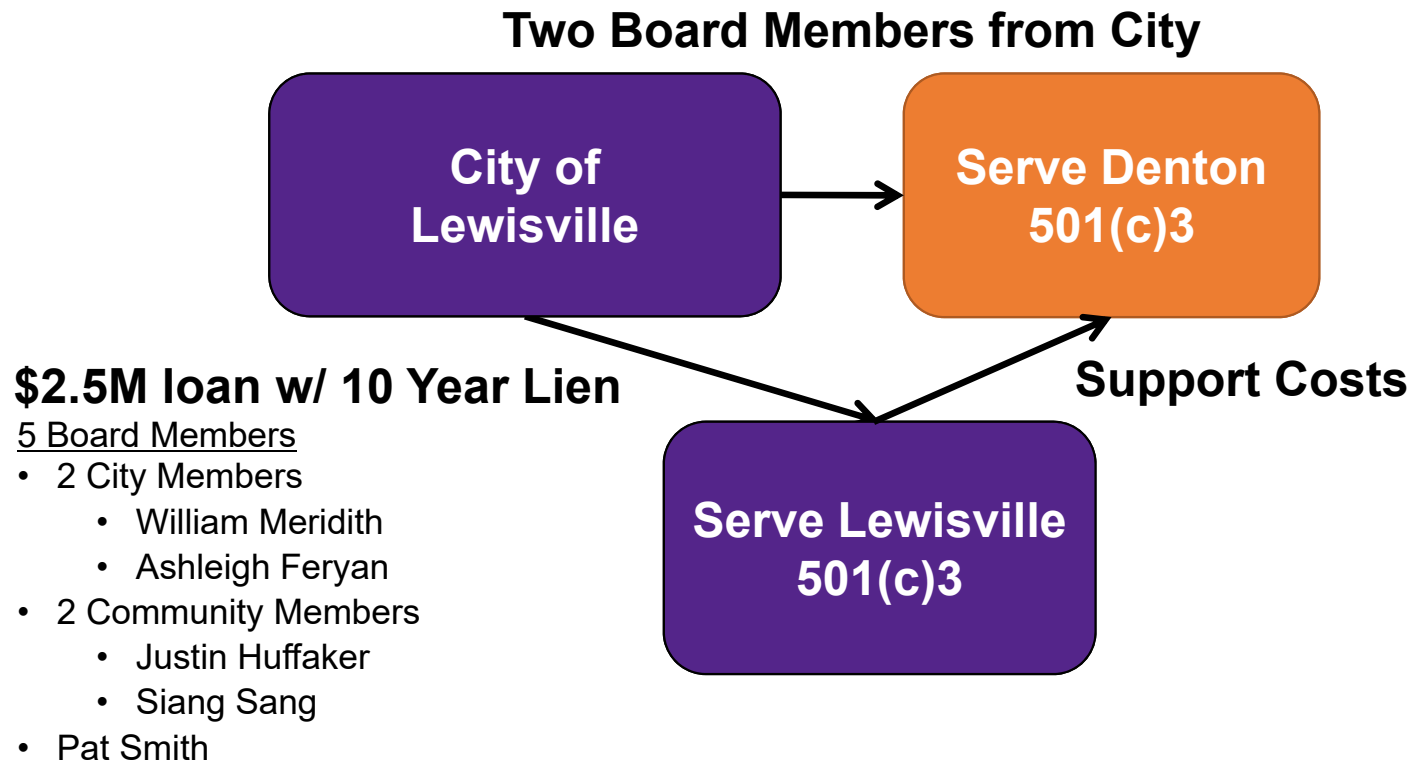



Our programs and partners

Partnership

Nonprofits who have office space onsite; access to shared spaces and resources.



City of Lewisville
Co-Care Team



Grocery Services
North

Membership

Nonprofits who want access to shared spaces and resources.

Applications out to two agencies

Phase 2: 1st floor plan

Copyright Serve Lewisville 2023

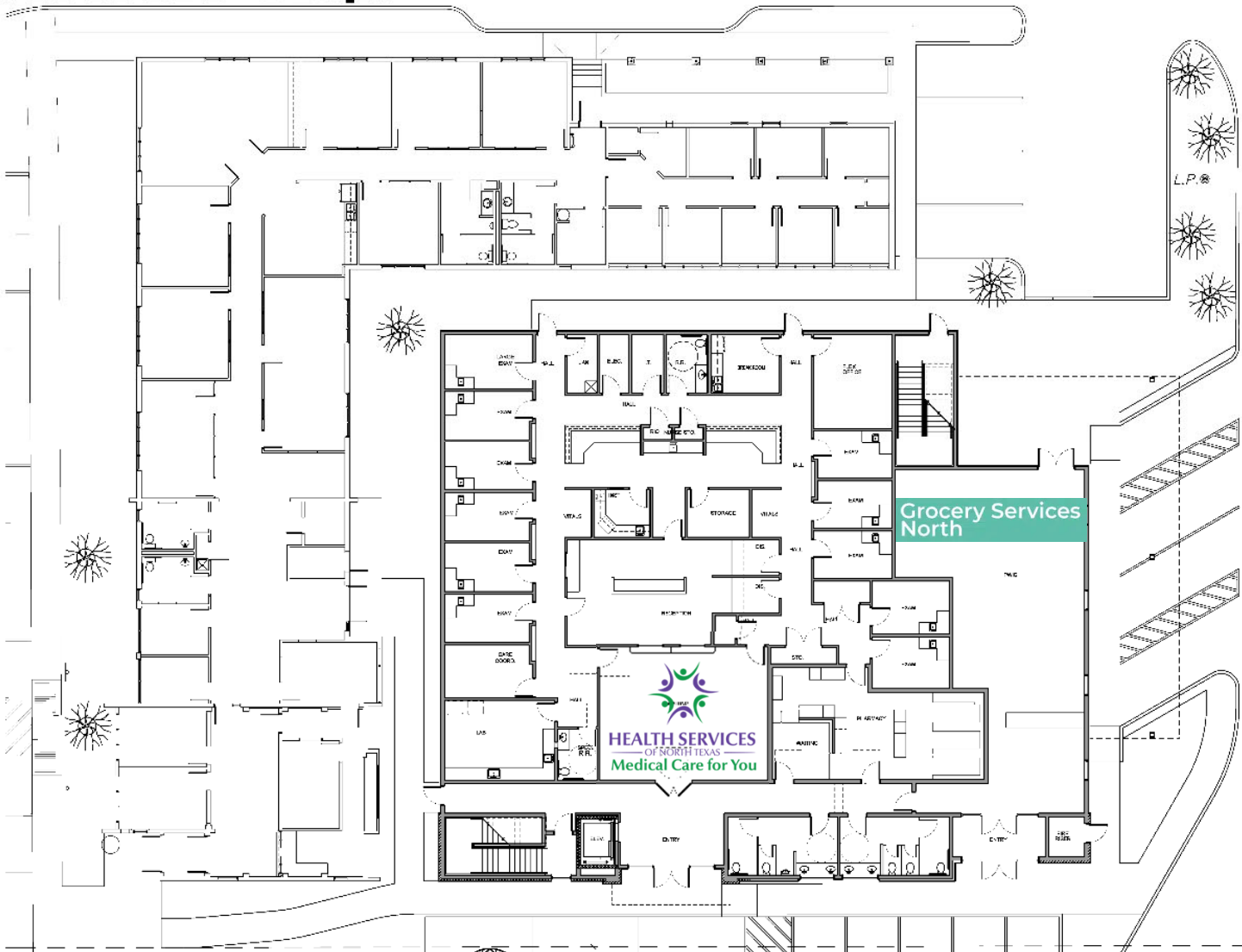

B. BATESMARTIN ARCHITECTS
 Michael A. Bates, Architect Mark M. Martin, Architect
 100 West Oak St., Suite 201 Denton, TX 76201 (940) 387-4881
 © Bates & Martin Architects, LLC. All rights reserved.

Tenant Finish Out For:
Serve Lewisville
 Phase 2
 1001 Edmonds Road Lewisville, TX 75067

THIS DOCUMENT IS THE PROPERTY OF BATES & MARTIN ARCHITECTS, LLC. IT IS TO BE USED ONLY FOR THE PROJECT AND SITE SPECIFICALLY IDENTIFIED HEREON. NO PART OF THIS DOCUMENT IS TO BE REPRODUCED OR TRANSMITTED IN ANY FORM OR BY ANY MEANS, ELECTRONIC OR MECHANICAL, INCLUDING PHOTOCOPYING, RECORDING, OR BY ANY INFORMATION STORAGE AND RETRIEVAL SYSTEM, WITHOUT THE WRITTEN PERMISSION OF BATES & MARTIN ARCHITECTS, LLC.

BMA	PROJECT NO:	21-113
DATE:	5/10/2023	
REV		
REV		

Phase 2: 2nd floor plan

Copyright Serve Lewisville 2023



2nd FLOOR PLAN
SCALE: 1/8" = 1'-0"



Tenant Finish Out For:
Serve Lewisville
Phase 2
1001 Edmonds Road Lewisville, TX 75067



THIS DOCUMENT IS
RELEASED FOR THE
PURPOSE OF INTER-
REVIEW. WITHOUT THE
AUTHORITY OF THE
ARCHITECT, NO
IT IS NOT TO BE USED
FOR REGULATORY
APPROVAL, PERMITTING
OR CONSTRUCTION.

BMA
PROJECT NO: 21-113
DATE: 6/18/2023
REV
REV

2nd Floor Plan