

File: Z:\2018\18096\Drawings\2018\18096_VARIANCE EXHIBIT
Plotted: 9/26/2018 9:51 AM by Road River, Saved: 9/26/2018 9:50 AM by Road

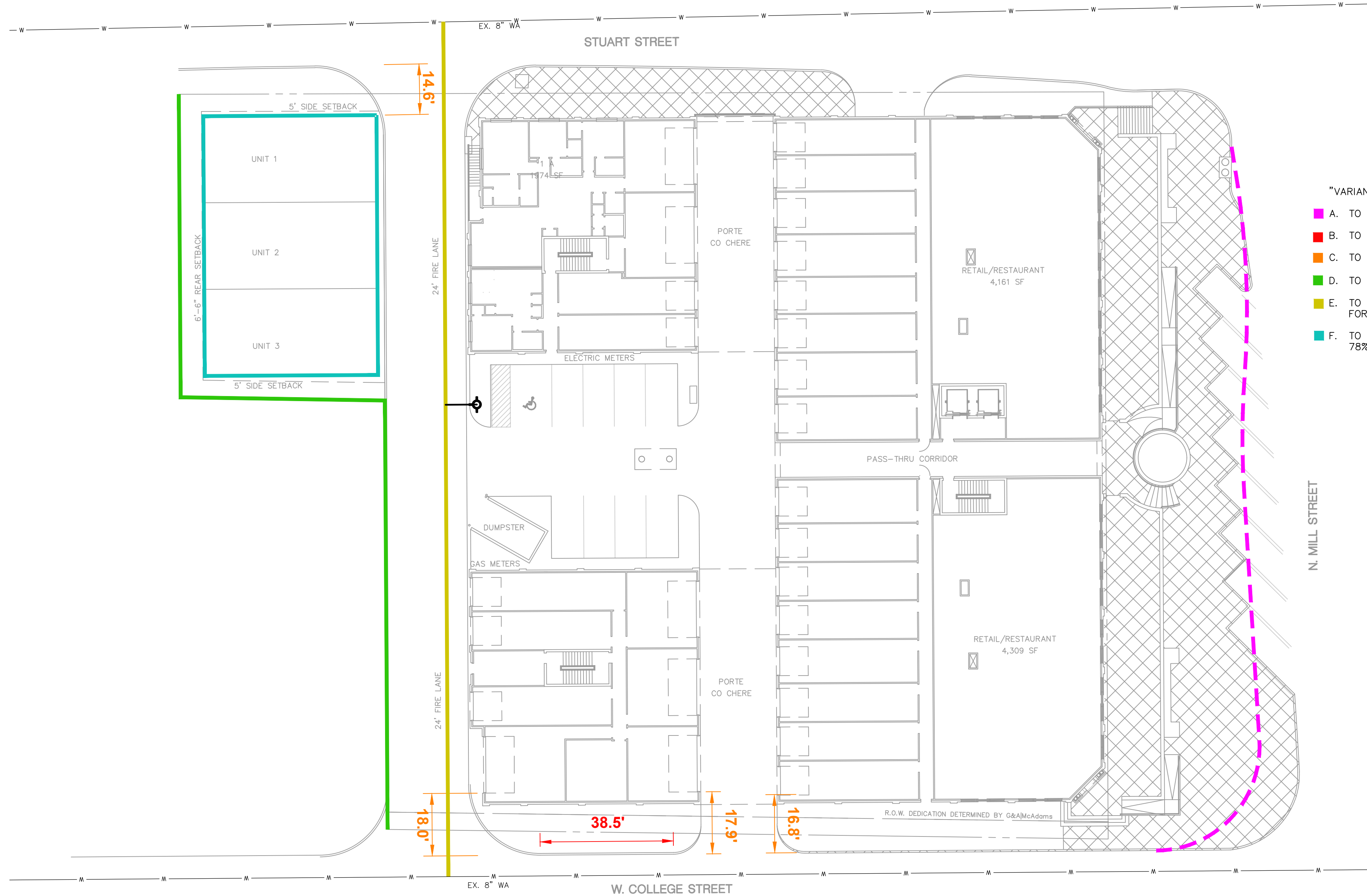

- *VARIANCES APPROVED BY CITY COUNCIL ON _____
- A. TO NOT REQUIRE A RIGHT TURN LANE ON MILL ST. AND COLLEGE ST.
 - B. TO REDUCE THE 50-FT DRIVEWAY SPACING ALONG COLLEGE STREET TO 38.5 FEET.
 - C. TO REDUCE THE 40-FT DRIVEWAY STACKING REQUIREMENT TO BE A RANGE OF 18.0 FEET TO 14.6 FEET.
 - D. TO ALLOW A 6' BOARD ON BOARD WOOD FENCE IN LIEU OF REQUIRED 6' MASONRY SCREENING.
 - E. TO ALLOW A PUBLIC WATER LINE TO BE INSTALLED UNDERNEATH PAVEMENT. PROPERTY OWNER TO BE RESPONSIBLE FOR PAVEMENT REPAIR OR REPLACEMENT AFTER ANY FUTURE WORK ON THE WATER LINE.
 - F. TO ALLOW FOR A MATERIAL DEVIATION FOR THE WESTERN CONDO BUILDING CONSISTING OF 22% BRICK AND STONE AND 78% WOOD AND FIBER CEMENT BOARD..

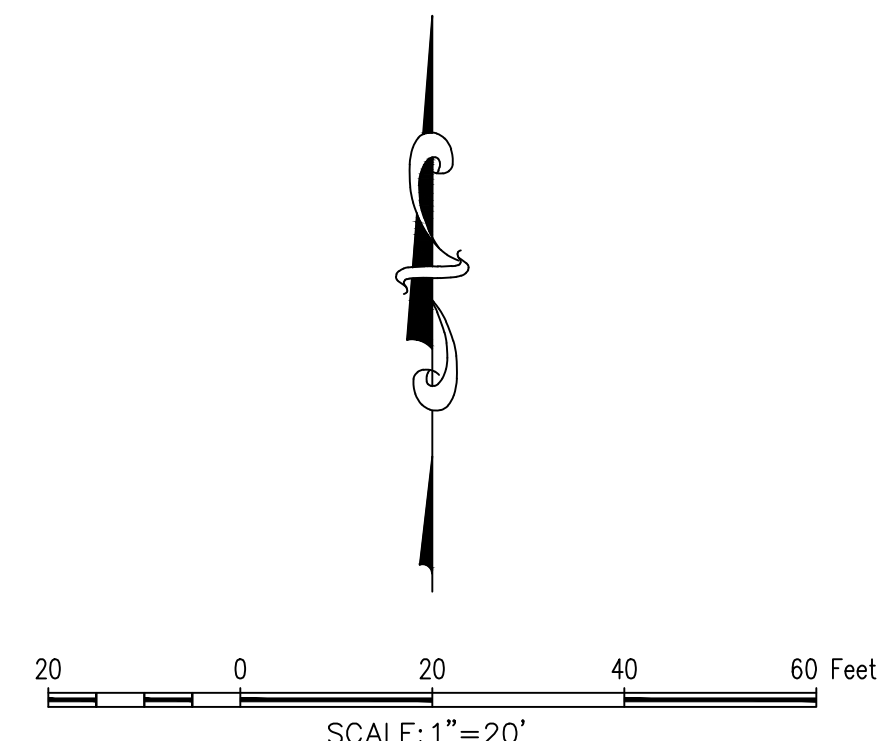

OWNER/DEVELOPER
BENNY JAFARI AND HENRY RAHMANI
1800 VALLEY VIEW LANE SUITE 320
Ph. 469-592-7200

MILL STREET LOFTS
1.142 Acres
in the
J.W. KING SURVEY, ABSTRACT NO. 696
JACKSON TRUST ADDITION
DENTON COUNTY, TEXAS

Variance Exhibit

PRELIMINARY PLANS
THIS DOCUMENT IS FOR
INTERIM REVIEW AND IS
NOT INTENDED FOR
CONSTRUCTION, BIDDING,
OR PERMIT PURPOSES.
G&A | MCADAMS,
TBPE: 19762
JOSHUA M. BARTON,
P.E. #129227
DATE 9/26/2018

Drawn By: PF
Date: 09/04/2018
Scale: 1"=20'
Revisions:
09/19/2018
09/26/2018

18096

VE

The John R. McAdams
Company, Inc.
(DBA, G&A | McAdams)
111 Hillside Drive
Lewisville, Texas 75057
972.436.9712
201 Country View Drive
Rockwall, Texas 75087
940.248.1011
TBPE: 19762 TBPLS: 10194440
www.gacom.com
www.mcadamsco.com

MCADAMS

G&A

MILL STREET LOFTS